

# KAYNAK BOYUNLU FLANŞ 300 LB



ASME B 16.5 - 2013  
BS 3293



**E.M.P.**  
www.emp.com.tr  
www.empflans.com

# WELDING NECK FLANGE CLASS 300



ASME B 16.5 - 2013  
BS 3293

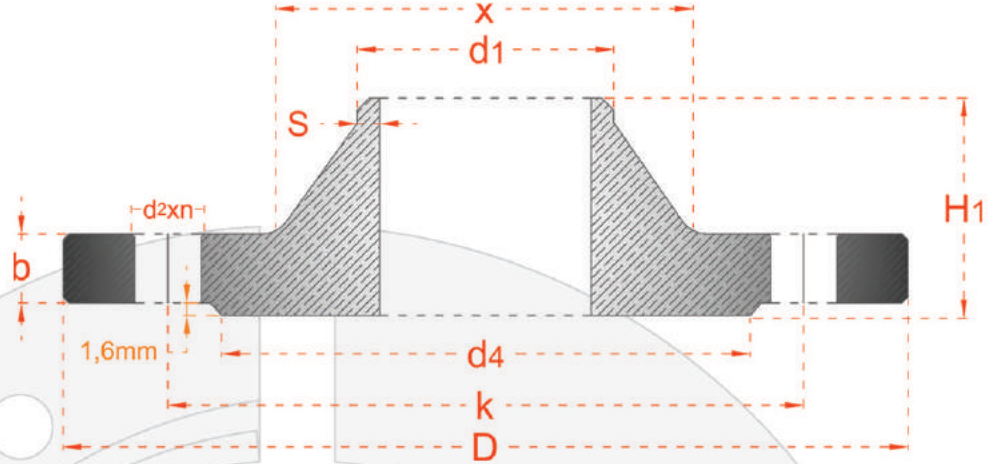

ASME B 16.5-2013													AĞIRLIK WEIGHT
DN	NPS	D	b	d4	DELİKLER - DRILLINGS			s	X	d1	H1	kg	
					n	k	d2						
15	1/2"	95	14.3	34.9	4	66.7	15.8	S DEĞERİ MÜŞTERİ İLE GÖRÜŞÜLEREK BELİRLENECEKTİR	38	21.3	51	1.5	
20	3/4"	115	15.9	42.9	4	82.6	19.0		48	26.7	56	1.8	
25	1"	125	17.5	50.8	4	88.9	19.0		54	33.4	60	2.0	
32	1 1/4"	135	19.1	63.5	4	98.4	19.0		63	42.2	64	2.5	
40	1 1/2"	155	20.7	73.0	4	114.3	22.2		70	48.3	67	3.5	
50	2"	165	22.3	92.1	8	127.0	19.0		84	60.3	68	4.0	
65	2 1/2"	190	25.4	104.8	8	149.2	22.2		100	73.0	75	5.0	
80	3"	210	28.6	127.0	8	168.3	22.2		117	88.9	78	7.0	
	3 1/2"	230	30.2	139.7	8	184.1	22.2		133	101.6	79	9.2	
100	4"	255	31.8	157.2	8	200.0	22.2		146	114.3	84	11	
125	5"	280	35.0	185.7	8	235.0	22.2		178	141.3	97	14	
150	6"	320	36.6	215.9	12	269.9	22.2		206	168.3	97	19	
200	8"	380	41.3	269.9	12	330.2	25.4		260	219.1	110	30	
250	10"	445	47.7	323.8	16	387.4	28.5		321	273.0	116	41	
300	12"	520	50.8	381.0	16	450.8	31.8		375	323.8	129	62	
350	14"	585	54.0	412.8	20	514.4	31.8		425	355.6	141	84	
400	16"	650	57.2	469.9	20	571.5	35.0		483	406.4	144	111	
450	18"	710	60.4	533.4	24	628.6	35.0		533	457.0	157	138	
500	20"	775	63.5	584.2	24	685.8	35.0		587	508.0	160	171	
600	24"	915	69.9	692.2	24	812.8	41.1		702	610.0	167	247	
BS 3293													
650	26"	971.5	79.2	749.3	28	876.3	44.4	S DEĞERİ MÜŞTERİ İLE GÖRÜŞÜLEREK BELİRLENECEKTİR	720.7	666.7	184.1	288	
700	28"	1,035.0	85.8	800.1	28	939.8	44.4		774.7	717.5	196.8	340	
750	30"	1092.2	91.9	857.2	28	996.9	47.7		827.1	768.3	209.5	406	
800	32"	1149.3	98.5	914.4	28	1054.1	50.8		881.1	819.1	222.2	468	
850	34"	1206.5	101.6	965.2	28	1104.9	50.8		936.6	871.6	231.8	524	
900	36"	1,270.0	104.6	1022.3	32	1168.4	53.8		990.6	922.4	241.3	606	

Ölçüler mm olarak verilmiştir.  
Çelik ve paslanmaz üretilebilir.

Dimensions are in mm.  
Steel and stainless steel can be produce.