

## KÖR FLANŞ PN 40



TS EN 1092 - 1 + A1 TİP 5  
DIN 2527 PN 40



**E.M.P.**  
www.emp.com.tr  
www.empflans.com

## BLIND FLANGE PN 40



EN 1092 - 1 + A1 TYPE 5  
DIN 2527 PN 40

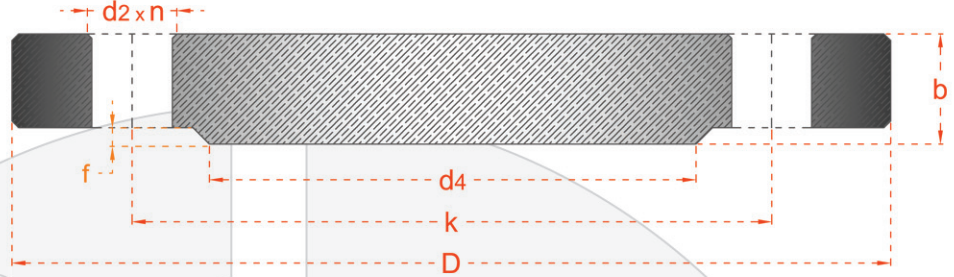

BORU/PİPE	FLANŞ/FLANGE		ALIN/ RAISED FACE		DELİKLER/DRILLINGS				AĞIRLIK WEIGHT	
DN	D	b		d <sub>4</sub>	f	k	n	vida/screw	d <sub>2</sub>	DIN / kg
		EN 1092-1	DIN							
10	90	16	16	40	2	60	4	M12	14	0.7
15	95	16	16	45	2	65	4	M12	14	0.8
20	105	18	18	58	2	75	4	M12	14	1.0
25	115	18	18	68	2	85	4	M12	14	1.4
32	140	18	18	78	2	100	4	M16	18	2.0
40	150	18	18	88	3	110	4	M16	18	2.4
50	165	20	20	102	3	125	4	M16	18	3.2
65	185	22	22	122	3	145	8	M16	18	4.3
80	200	24	24	138	3	160	8	M16	18	5.5
100	235	24	24	162	3	190	8	M20	22	7.6
125	270	26	26	188	3	220	8	M24	26	10.8
150	300	28	28	218	3	250	8	M24	26	14.6
200	375	36	34	285	3	320	12	M27	30	27.2
250	450	38	38	345	4	385	12	M30	33	44.4
300	515	42	42	410	4	450	16	M30	33	64.1
350	580	46	46	465	4	510	16	M33	36	89.5
400	660	50	50	535	4	585	16	M36	39	126.7
450	685	57	50	560	4	610	20	M36	39	140.6
500	755	57	52	615	4	670	20	M39	42	171.4
600	890	72	56	735	5	795	20	M45	48	257.4

Ölçüler mm olarak verilmiştir.  
Çelik ve paslanmaz üretilebilir.

Dimensions are in mm.  
Steel and stainless steel can be produce.