

EŞİT TE



ASME B 16.9
MSS - SP 75
STD - SCH X.S. - X.X.S. - 10 - 20 - 30



E.M.P.
www.emp.com.tr
www.empflans.com

EQUAL TEE



ASME B 16.9
MSS - SP 75
STD - SCH X.S. - X.X.S. - 10 - 20 - 30

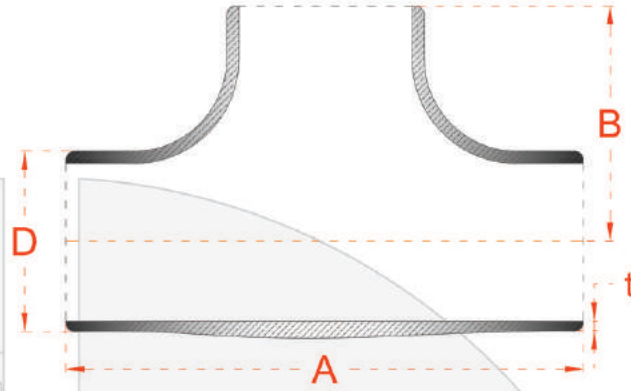

DN	INCH	DIŞ ÇAP DİAMETER		STD		SCH X.S.		SCH X.X.S.		SCH 10		SCH 20		SCH 30		
		D	A	B	t	kg	t	kg	t	kg	t	kg	t	kg		
10	1/2"	21	50	25	2.77	0.16	3.73	0.25	X	X	X	X	X	2.41	X	
15	3/4"	27	58	29	2.87	0.20	3.91	0.27	7.82	0.38	X	X	X	2.41	X	
25	1"	33	76	38	3.38	0.29	4.55	0.35	9.09	0.58	X	X	X	2.90	X	
32	1 1/4"	42	96	48	3.56	0.53	4.85	0.65	9.70	1.05	X	X	X	2.97	X	
40	1 1/2"	48	114	57	3.68	0.77	5.08	0.96	10.16	1.56	X	X	X	3.18	X	
50	2"	60	128	64	3.91	1.88	5.54	1.90	11.07	2.69	X	X	X	3.18	X	
65	2 1/2"	73	152	76	5.16	2.69	7.01	3.07	14.02	4.54	X	X	X	4.78	X	
80	3"	89	172	86	5.49	3.82	7.62	4.50	15.24	7.63	X	X	X	4.78	X	
	3 1/2"	102	190	95	5.74	5.18	8.08	6.17	X	X	X	X	X	4.78	X	
100	4"	114	210	105	6.02	6.00	8.56	8.44	17.12	17.0	X	X	X	4.78	X	
125	5"	141	248	124	6.55	9.94	9.52	12.94	19.05	25.0	X	X	X	X	X	
150	6"	168	286	143	7.11	16.48	10.97	19.30	21.95	39.0	X	X	X	X	X	
200	8"	219	356	178	8.18	33.00	12.7	34.50	22.23	69.0	X	X	6.35	29.0	7.03	31.00
250	10"	273	432	216	9.27	49.35	12.7	58.57	25.40	98.0	X	X	6.35	34.7	7.80	36.77
300	12"	324	508	254	9.52	65.0	12.7	84.90	25.40	150	X	X	6.35	59.0	8.38	61.74
350	14"	356	558	279	9.52	93.0	12.7	127.12	X	X	6.35	87.16	7.92	90.0	9.52	93.00
400	16"	406	610	305	9.52	115	12.7	167.52	X	X	6.35	90.80	7.92	100	9.52	115.0
450	18"	457	686	343	9.52	135	12.7	190	X	X	6.35	94.50	7.92	127.12	11.13	181.14
500	20"	508	762	381	9.52	168	12.7	245	X	X	6.35	120	9.52	168	12.70	265.0
550	22"	559	838	419	9.52	200	12.7	280	X	X	6.35	143	9.52	200	12.70	355.0
600	24"	610	864	432	9.52	240	12.7	350	X	X	6.35	170	9.52	240	14.27	443.55
650	26"	660	990	495	9.52	288	12.7	361	X	X	7.92	240	12.7	360.50	X	X
700	28"	711	1042	521	9.52	337	12.7	421	X	X	7.92	280	12.7	421	15.88	526
750	30"	762	1118	559	9.52	388.50	12.7	483.50	X	X	7.92	322	12.7	483.50	15.88	604
800	32"	813	1194	597	9.52	451	12.7	559	X	X	7.92	375	12.7	559	15.88	699
850	34"	864	1270	635	9.52	516	12.7	645	X	X	7.92	429	12.7	645	15.88	805
900	36"	914	1346	673	9.52	587.50	12.7	731	X	X	7.92	488	12.7	731	15.88	913
950	38"	965	1422	711	9.52	638	12.7	812	X	X	X	X	X	X	X	X
1000	40"	1016	1498	749	9.52	690	12.7	894	X	X	X	X	X	X	X	X
1050	42"	1067	1524	711	9.52	831	12.7	1045	X	X	X	X	X	X	X	X
1100	44"	1118	1626	762	9.52	899	12.7	1194	X	X	X	X	X	X	X	X
1150	46"	1168	1702	800	9.52	1007	12.7	1346	X	X	X	X	X	X	X	X
1200	48"	1219	1778	838	9.52	1112.5	12.7	1498.50	X	X	X	X	X	X	X	X

Ölçüler mm olarak verilmiştir.
Çelik ve paslanmaz üretilebilir.

Dimensions are in mm.
Steel and stainless steel can be produce

EŞİT TE



ASME B 16.9
MSS - SP 75
STD - SCH X.S. - X.X.S. - 40 - 60 - 80



E.M.P.
www.emp.com.tr
www.empflans.com

EQUAL TEE



ASME B 16.9
MSS - SP 75
STD - SCH X.S. - X.X.S. - 40 - 60 - 80

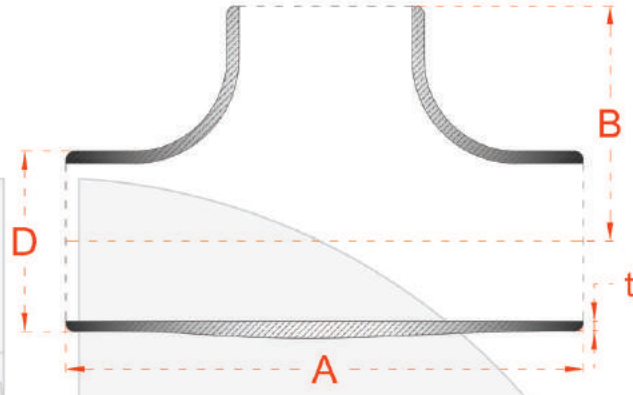

DN	INCH	DIŞ ÇAP DİAMETER		STD		SCH X.S.		SCH X.X.S.		SCH 40		SCH 60		SCH 80		
		D	A	B	t	kg	t	kg	t	kg	t	kg	t	kg	t	kg
10	1/2"	21	50	25	2.77	0.16	3.73	0.25	X	X	2.77	0.16	X	X	3.73	0.25
15	3/4"	27	58	29	2.87	0.20	3.91	0.27	7.82	0.38	2.87	0.20	X	X	3.91	0.27
25	1"	33	76	38	3.38	0.29	4.55	0.35	9.09	0.58	3.38	0.29	X	X	4.55	0.35
32	1 1/4"	42	96	48	3.56	0.53	4.85	0.65	9.70	1.05	3.56	0.53	X	X	4.85	0.65
40	1 1/2"	48	114	57	3.68	0.77	5.08	0.96	10.16	1.56	3.68	0.77	X	X	5.08	0.96
50	2"	60	128	64	3.91	1.88	5.54	1.90	11.07	2.69	3.91	1.88	X	X	5.54	1.90
65	2 1/2"	73	152	76	5.16	2.69	7.01	3.07	14.02	4.54	5.16	2.69	X	X	7.01	3.07
80	3"	89	172	86	5.49	3.82	7.62	4.50	15.24	7.63	5.49	3.82	X	X	7.62	4.50
	3 1/2"	102	190	95	5.74	5.18	8.08	6.17	X	X	5.74	5.18	X	X	8.08	6.17
100	4"	114	210	105	6.02	6.00	8.56	8.44	17.12	17.0	6.02	6.00	X	X	8.56	8.44
125	5"	141	248	124	6.55	9.94	9.52	12.94	19.05	25.0	6.55	9.94	X	X	9.52	12.94
150	6"	168	286	143	7.11	16.48	10.97	19.30	21.95	39.0	7.11	16.48	X	X	10.97	19.30
200	8"	219	356	178	8.18	33.00	12.7	34.50	22.23	69.0	8.18	33.00	10.31	34.50	12.70	34.50
250	10"	273	432	216	9.27	49.35	12.7	58.57	25.40	98.0	9.27	49.35	12.70	58.57	15.09	68.00
300	12"	324	508	254	9.52	65.0	12.7	84.90	25.40	150	10.31	70.50	14.27	102.6	17.48	115
350	14"	356	558	279	9.52	93.0	12.7	127.12	X	X	11.13	114.41	15.09	141.20	19.05	165
400	16"	406	610	305	9.52	115	12.7	167.52	X	X	12.70	167.52	16.66	207.93	21.44	249
450	18"	457	686	343	9.52	135	12.7	190	X	X	14.27	238.35	19.05	277.85	23.83	322
500	20"	508	762	381	9.52	168	12.7	245	X	X	15.09	320.52	20.62	378.64	26.18	459.05
550	22"	559	838	419	9.52	200	12.7	280	X	X	17.48	X	22.22	510.00	28.58	600
600	24"	610	864	432	9.52	240	12.7	350	X	X	17.48	570.68	24.61	656.48	30.96	748
650	26"	660	990	495	9.52	288	12.7	361	X	X	X	X	X	X	X	X
700	28"	711	1042	521	9.52	337	12.7	421	X	X	X	X	X	X	X	X
750	30"	762	1118	559	9.52	388.50	12.7	483.50	X	X	X	X	X	X	X	X
800	32"	813	1194	597	9.52	451	12.7	559	X	X	17.48	769	X	X	X	X
850	34"	864	1270	635	9.52	516	12.7	645	X	X	17.48	886	X	X	X	X
900	36"	914	1346	673	9.52	587.50	12.7	731	X	X	19.05	1004	X	X	X	X
950	38"	965	1422	711	9.52	638	12.7	812	X	X	X	X	X	X	X	X
1000	40"	1016	1498	749	9.52	690	12.7	894	X	X	X	X	X	X	X	X
1050	42"	1067	1524	711	9.52	831	12.7	1045	X	X	X	X	X	X	X	X
1100	44"	1118	1626	762	9.52	899	12.7	1194	X	X	X	X	X	X	X	X
1150	46"	1168	1702	800	9.52	1007	12.7	1346	X	X	X	X	X	X	X	X
1200	48"	1219	1778	838	9.52	1112.5	12.7	1498.50	X	X	X	X	X	X	X	X

Ölçüler mm olarak verilmiştir.
Çelik ve paslanmaz üretilebilir.

Dimensions are in mm.
Steel and stainless steel can be produce