

# DÖVME ÇELİK, SOKETLİ FİTTINGS ÖLÇÜLERİ



3000 LB & 6000 LB  
ANSI B 16.11



**E.M.P.**  
www.emp.com.tr  
www.empflans.com

# DIMENSIONS OF SOCKET WELDING FITTINGS



3000 LB & 6000 LB  
ANSI B 16.11

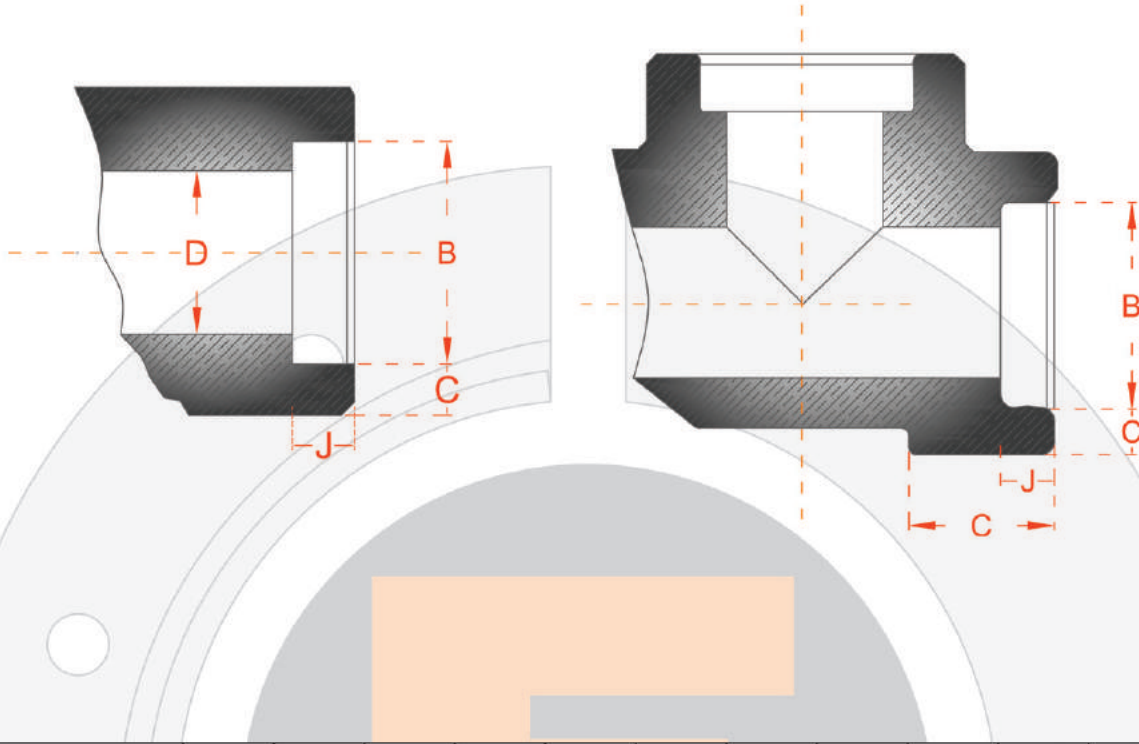

E.M.P.		1/8"	1/4"	3/8"	1/2"	3/4"	1"	1 1/4"	1 1/2"	2"	2 1/2"	3"	4"	
B	min.	10.65	14.10	17.55	21.70	27.05	33.80	42.55	48.65	61.10	73.80	89.80	115.45	
	max.	10.90	14.35	17.80	21.95	27.30	34.05	42.80	48.90	61.35	74.20	90.15	115.80	
D	3000 LB	min.	6.10	8.50	11.80	15.00	20.20	25.90	34.30	40.10	51.70	61.20	76.40	100.70
		max.	7.60	10.00	13.30	16.60	21.70	27.40	35.80	41.70	53.50	64.20	79.50	103.80
	6000 LB	min.	3.20	5.60	8.40	11.00	14.80	19.90	28.70	33.20	42.10			
		max.	4.80	7.10	9.90	12.50	16.30	21.50	30.20	34.70	43.60			
C	3000 LB	med.	3.20	3.80	4.00	4.65	4.90	5.70	6.05	6.35	6.95	8.75	9.50	10.70
		min.	3.20	3.30	3.50	4.10	4.25	5.00	5.30	5.55	6.05	7.65	8.30	9.35
	6000 LB	med.	3.95	4.60	5.05	5.95	6.95	7.90	7.90	8.90	10.90			
		min.	3.45	4.00	4.35	5.20	6.05	6.95	6.95	7.80	9.50			
G min.	3000 LB	2.40	3.00	3.20	3.75	3.90	4.55	4.85	5.10	5.55	7.00	7.60	8.55	
	6000 LB	3.15	3.70	4.00	4.80	5.55	6.35	6.35	7.15	8.75				
J min.		10.00	10.00	10.00	10.00	13.00	13.00	13.00	13.00	16.00	16.00	16.00	19.00	

DÖVME ÇELİK SOKETLİ TABLOLARINDA BULUNMAYAN ÖLÇÜLER İÇİN ORTAK OLARAK BU TABLO KULLANILACAKTIR  
THIS TABLE IS GOING TO BE USE FOR SIZES WHICH ARE NOT BE ON FORGED STEEL FITTINGS TABLES