

KÖR FLANŞ PN 63



TS EN 1092 - 1 + A1 TİP 5
DIN 2527 PN 63



E.M.P.
www.emp.com.tr
www.empflans.com

BLIND FLANGE PN 63



EN 1092 - 1 + A1 TYPE 5
DIN 2527 PN 63

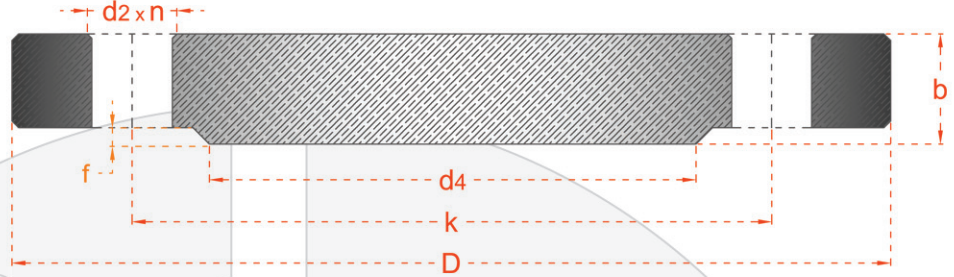

BORU/PİPE	FLANŞ/FLANGE		ALIN /RAISED FACE		DELİKLER/DRILLINGS				AĞIRLIK WEIGHT	
DN	D	b		d ₄	f	k	n	vida /screw	d ₂	DIN /kg
		EN 1092-1	DIN							
10	100	20	20	40	2	70	4	M12	14	1.1
15	105	20	20	45	2	75	4	M12	14	1.3
20	130	22	22	58	2	90	4	M16	18	2.1
25	140	24	24	68	2	100	4	M16	18	2.7
32	155	24	24	78	2	110	4	M20	22	3.3
40	170	26	26	88	2	125	4	M20	22	4.3
50	180	26	26	102	3	135	4	M20	22	4.8
65	205	26	26	122	3	160	8	M20	22	5.9
80	215	28	28	138	3	170	8	M20	22	7.0
100	250	30	30	162	3	200	8	M24	26	10.2
125	295	34	34	188	3	240	8	M27	30	16.4
150	345	36	36	218	3	280	8	M30	33	24.5
200	415	42	42	285	3	345	12	M33	36	40.5
250	470	46	46	345	3	400	12	M33	36	57.4
300	530	52	52	410	4	460	16	M33	36	81.0
350	600	56	56	465	4	525	16	M36	39	111.5
400	670	60	60	535	4	585	16	M39	42	155.5

Ölçüler mm olarak verilmiştir.
Çelik ve paslanmaz üretilebilir.

Dimensions are in mm.
Steel and stainless steel can be produce.