

## KÖR FLANŞ PN 10



TS EN 1092 - 1 + A1 TİP 5  
DIN 2527 PN 10



**E.M.P.**  
www.emp.com.tr  
www.empflans.com

## BLIND FLANGE PN 10



EN 1092 - 1 + A1 TYPE 5  
DIN 2527 PN 10

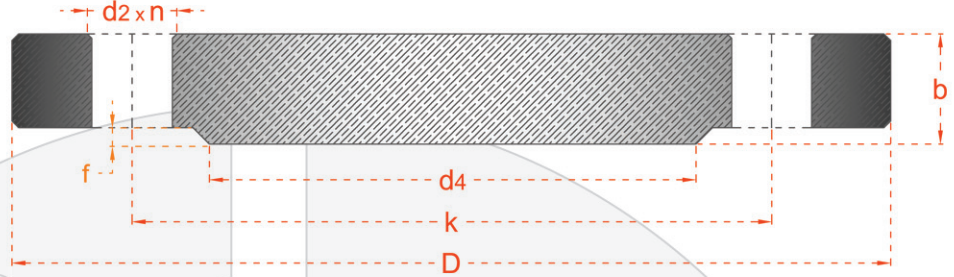

BORU/PIPE	FLANŞ /FLANGE		ALIN /RAISED FACE		DELİKLER/DRILLINGS				AĞIRLIK WEIGHT	
DN	D	b		d <sub>4</sub>	f	k	n	vida/screw	d <sub>2</sub>	kg
		EN 1092-1	DIN							
10	90	16	14	40	2	60	4	M12	14	
15	95	16	14	45	2	65	4	M12	14	0.63
20	105	18	16	58	2	75	4	M12	14	0.88
25	115	18	16	68	2	85	4	M12	14	1.23
32	140	18	16	78	2	100	4	M16	18	1.80
40	150	18	16	88	3	110	4	M16	18	2.09
50	165	18	18	102	3	125	4	M16	18	2.56
65	185	18	18	122	3	145	4	M16	18	3.65
80	200	20	20	138	3	160	8	M16	18	4.15
100	220	20	20	158	3	180	8	M16	18	5.65
125	250	22	22	188	3	210	8	M16	18	7.38
150	285	22	22	212	3	240	8	M20	22	10.49
200	340	24	24	268	3	295	8	M20	22	15.15
250	395	26	26	320	3	350	12	M20	22	22.22
300	445	26	26	370	4	400	12	M20	22	30.80
350	505	26	26	430	4	460	16	M20	22	39.62
400	565	26	26	482	4	515	16	M24	26	49.41
450	615	28	28	532	4	565	20	M24	26	58.43
500	670	28	28	585	4	620	20	M24	26	75.12
600	780	34	28	685	5	725	20	M27	30	101.87
700	895	38	30	800	5	840	24	M27	30	144.00
800	1015	48	32	905	5	950	24	M30	33	198.00
900	1115	50	34	1005	5	1050	28	M30	33	254.00
1000	1230	54	34	1110	5	1160	28	M33	36	309.37
1200	1455	66	38	1330	5	1380	32	M36	39	484.34
1400	1675	müşteri tarafından belirlenecektir	42	1535	5	1590	36	M39	42	709.70
1600	1915		46	1760	5	1820	40	M45	48	1,013.40
1800	2115		50	1960	5	2020	44	M45	48	1,349.86
2000	2325		54	2170	5	2230	48	M45	48	1,761.98

Ölçüler mm olarak verilmiştir.  
Çelik ve paslanmaz üretilebilir.

Dimensions are in mm.  
Steel and stainless steel can produce.