

KAYNAK BOYUNLU FLANŞ 300 LB



MSS - SP 44
ASME B 16.47 2006 SERIE A



E.M.P.
www.emp.com.tr
www.empflans.com

WELDING NECK FLANGE CLASS 300



MSS - SP 44
ASME B 16.47 2006 SERIE A

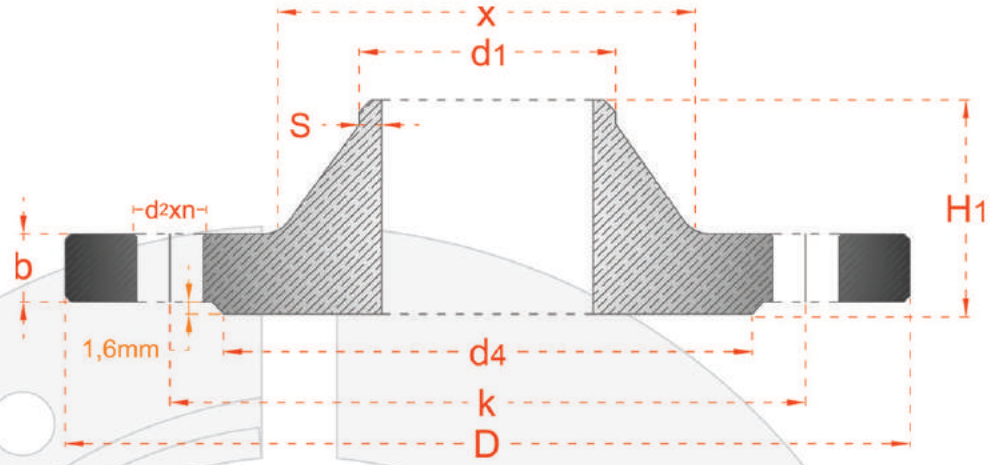

MSS - SP 44 ASME B16.47 2006 SERIE A											AĞIRLIK WEIGHT	
DN	NPS	D	b	d4	DELİKLER - DRILLINGS			s	X	d1	H1	kg
					n	k	d2					
650	26"	971.5	79.2	749.3	28	876.3	44.4	S DEĞERİ MÜŞTERİ İLE GÖRÜŞÜLEREK BELİRLENECEKTİR	720.8	660.4	184.1	288
700	28"	1,035.0	85.8	800.1	28	939.8	44.4		774.7	711.2	196.8	340
750	30"	1092.2	91.9	857.2	28	996.9	47.7		827	762.0	209.5	406
800	32"	1149.3	98.5	914.4	28	1054.1	50.8		881.1	812.8	222.2	468
850	34"	1206.5	101.6	965.2	28	1104.9	50.8		936.7	863.6	231.6	524
900	36"	1,270.0	104.6	1022.3	32	1168.4	53.8		990.6	914.4	241.3	606
950	38"	1168.4	107.9	1028.7	32	1092.2	41.1		993.6	965.2	180.8	333
1000	40"	1238.2	114.3	1085.8	32	1155.7	44.4		1047.7	1,016.0	193.8	399
1050	42"	1,289.0	119.1	1136.6	32	1206.5	44.4		1098.5	1066.8	200.1	444
1100	44"	1352.5	123.9	1193.8	32	1263.6	47.7		1149.3	1116.8	206.2	508
1150	46"	1,416.0	128.5	1244.6	28	1320.8	50.8		1203.4	1168.4	215.9	581
1200	48"	1466.8	133.3	1301.7	32	1371.6	50.8		1254.2	1219.2	223.7	620
1250	50"	1530.3	139.7	1358.9	32	1428.7	53.8		1,305.0	1,270.0	231.6	733
1300	52"	1581.1	144.5	1409.7	32	1479.5	53.8		1355.8	1320.8	238.2	773
1350	54"	1657.3	152.4	1466.8	28	1549.4	60.4		1409.7	1371.6	252.4	928
1400	56"	1708.1	153.9	1517.6	28	1600.2	60.4		1463.5	1422.4	260.3	986
1450	58"	1758.9	158.7	1574.8	32	1,651.0	60.4		1514.3	1473.2	266.7	1048
1500	60"	1809.7	163.5	1625.6	32	1701.8	60.4		1565.1	1,524.0	273.0	1120

Ölçüler mm olarak verilmiştir.
Çelik ve paslanmaz üretilebilir.

Dimensions are in mm.
Steel and stainless steel can be produce.