

# KAYNAK BOYUNLU FLANŞ 150 LB



MSS - SP44  
ASME B 16.47 2006 SERIE A



**E.M.P.**  
www.emp.com.tr  
www.empflans.com

# WELDING NECK FLANGE CLASS 150



MSS - SP44  
ASME B 16.47 2006 SERIE A

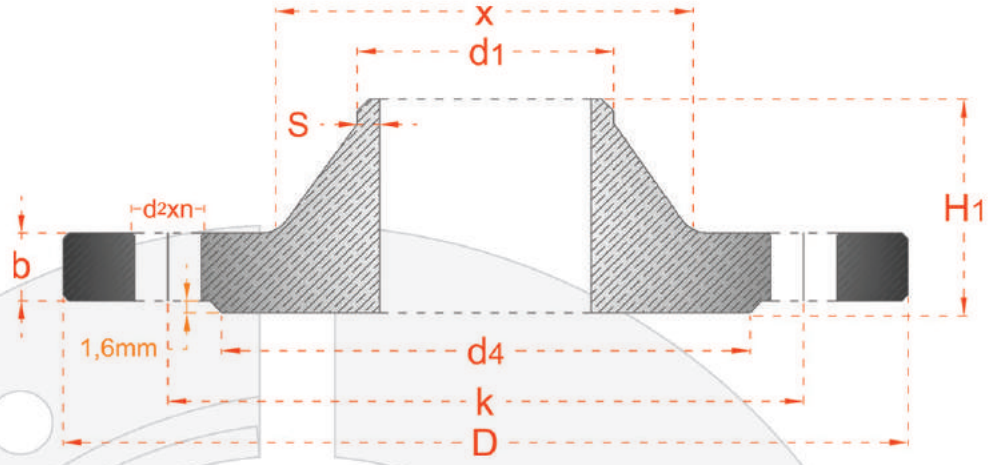

MSS -SP44 .ASME B 16.47 2006 SERIE A											AĞIRLIK WEIGHT	
DN	NPS	D	b	d4	DELİKLER - DRILLINGS			s	X	d1	H1	kg
					n	k	d2					
650	26"	869.9	68.3	749.3	24	806.4	35.0	S DEĞERİ MÜŞTERİ İLE GÖRÜŞÜLEREK BELİRLENECEKTİR	676.2	660.4	120.6	143
700	28"	927.1	71.4	800.1	28	863.6	35.0		726.9	711.2	125.4	185
750	30"	984.2	74.7	857.2	28	914.4	35.0		781.0	762.0	136.6	199
800	32"	1060.4	81.0	914.4	28	977.9	41.1		831.8	812.8	144.5	255
850	34"	1111.2	82.5	965.2	32	1028.7	41.1		882.6	863.6	149.3	275
900	36"	1168.4	90.4	1022.3	32	1085.8	41.1		933.4	914.4	157.2	367
950	38"	1238.2	87.4	1073.1	32	1149.3	41.1		990.6	965.2	157.2	381
1000	40"	1289	90.4	1123.9	36	1200.1	41.1		1041.4	1,016.0	163.5	393
1050	42"	1346.2	96.7	1193.8	36	1257.3	41.4		1092.2	1066.8	171.4	455
1100	44"	1403.3	101.6	1244.6	40	1314.4	41.4		1,143.0	1117.6	177.8	503
1150	46"	1454.1	103.1	1295.4	44	1365.2	41.4		1196.8	1168.4	185.6	529
1200	48"	1511.3	107.9	1358.9	44	1422.4	41.4		1247.6	1219.2	192.0	609
1250	50"	1568.5	111.2	1409.7	44	1479.5	47.7		1301.7	1,270.0	203.2	663
1300	52"	1625.6	115.8	1460.5	44	1536.7	47.7		1382.5	1320.8	209.5	741
1350	54"	1682.7	120.6	1511.3	44	1593.8	47.7		1403.3	1371.6	215.9	791
1400	56"	1746.2	123.9	1574.8	48	1,651.0	47.7		1457.5	1422.4	228.6	898
1450	58"	1803.4	128.5	1625.6	48	1708.1	47.7		1508.3	1473.2	234.9	967
1500	60"	1854.2	131.8	1676.4	52	1758.9	47.7	1559.1	1,524.0	239.7	1047	

Ölçüler mm olarak verilmiştir.  
Çelik ve paslanmaz üretilebilir.

Dimensions are in mm.  
Steel and stainless steel can be produce.

1/2" - 24" ARASI SAYFA (62) ASME 16.5 - 2013 BAKINIZ. / 1/2" to 24" SEE PAGE (62) ASME 16.5 - 2013  
60" ÜZERİ FİRMAMIZ TADAFINDAN ÜRETİLEBİLMEKTEDİR BİLGİ ALINIZ.